

VCO SBVC - 11

FEATURES

SINGLE BAND
6.0mm x 6.0mm x 1.8mm

IMAGE AREA

- ▶ Excellent C/N, S/N Ratio
- ▶ Low operating voltage
- ▶ High Accurate frequency tuning
- ▶ Strip line resonator

ELECTRICAL SPECIFICATIONS

| Parameters | CDMA | PCS / US | PCS / KOREA |
|-------------------------|-------------|--------------|--------------|
| Part No. | SBVC 11A | SBVC 11B | SBVC 11C |
| Frequency (MHz) | 967 ± 18.0 | 1750 ± 35.0 | 1635 ± 22.0 |
| Supply voltage (Volt) | 3.35 ± 0.15 | 3.0 ± 0.15 | 3.0 ± 0.15 |
| Control voltage (Volt) | 0.7~2.7 | 0.5~2.5 | 0.5~2.5 |
| Output level (dBm) | ≥ -3.0 | ≥ -3.0 | ≥ -3.0 |
| Current (mA) | ≤ 6.4 | ≤ 8.8 | ≤ 8.8 |
| C / N (dBc) | -110(30KHz) | -111(100KHz) | -111(100KHz) |
| Harmonics (dBc) | ≥ -15 | ≥ -15 | ≥ -15 |
| Frequency pushing (MHz) | ± 1 | ± 1 | ± 1 |
| Frequency pulling (MHz) | ± 1 | ± 1 | ± 1 |

DEMENSIONS

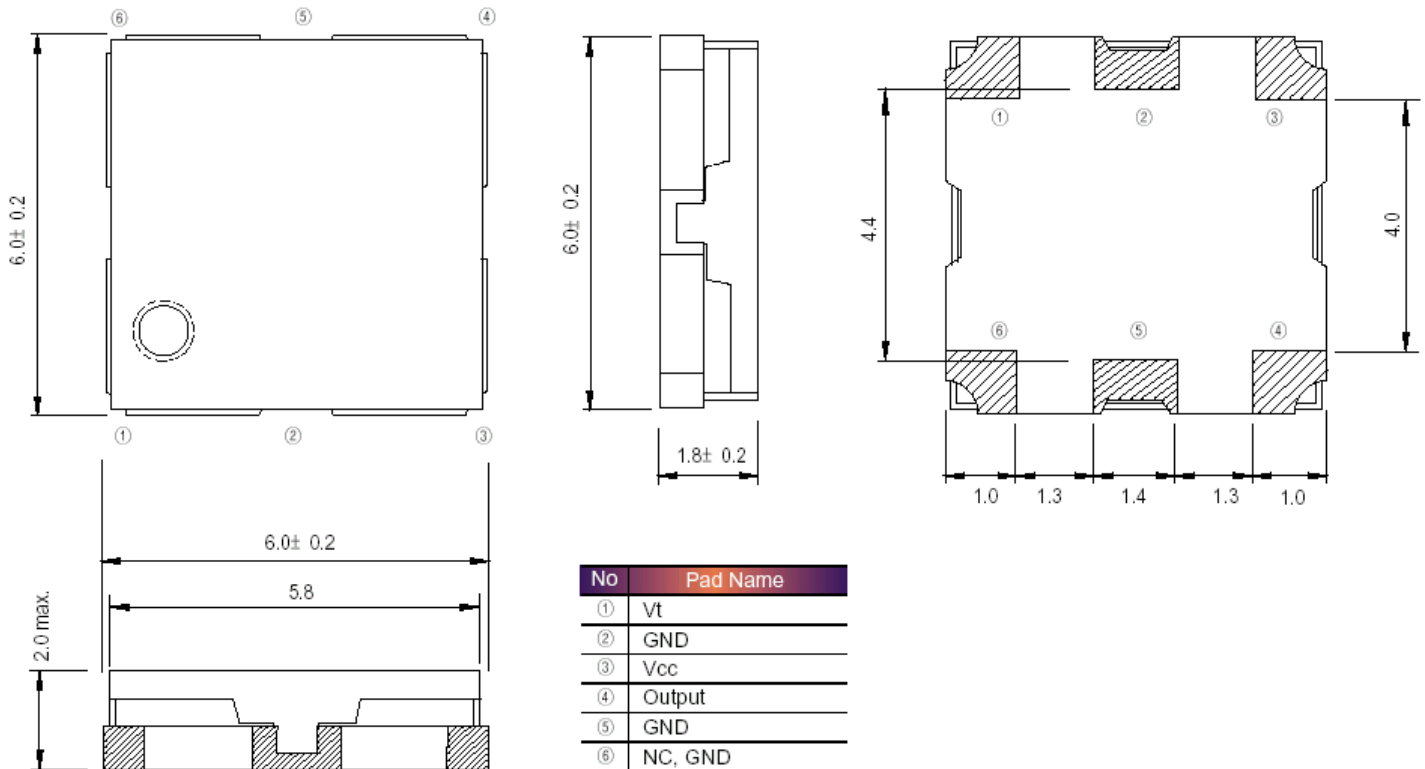

TEST CIRCUIT

